



## Club Notes



### **General Meeting:** September.. 18<sup>th</sup>.. 2018

Those with the Last name that begins with W-Z please bring finger food for the meeting. General Meetings are the third Tuesday off the Month at the church at 7:30pm. You are invited and encouraged to attend and bring a guest that might be interested in what we do. There is a silent auction and door prizes at every meeting.

**Next Board Meeting** The meeting will be September 11th. 2018 at 7:30 until 9:00 pm at the shop downstairs.

### **Next Show Meeting:**

Future show meetings will be on the second Tuesday of the month from 6:30 - 7:30



### In This Issue:

- ❖ Club Notes
- ❖ General Information
- ❖ Meeting Minutes
  - Board Meeting
  - June 13th.2018
  - General Meeting
  - June.8th,2018
- ❖ Rock Rumbles
- ❖ Announcements
- ❖ Show Schedules
- ❖ Field Trips
- ❖ Gem of the month
- ❖ Bench Tips by Brad Smith
- ❖ Kids Korner
- ❖ Shop Schedule
- ❖ Map To New General Meeting Place

## MGSCV Petrograph September 2018

### Monthly Bulletin of the Mineral and Gem Society of Castro Valley, inc.

This publication is the bulletin of the Mineral and Gem Society of Castro Valley, Inc., a member of the California Federation of Mineralogical Societies, Inc., the American Federation of Mineralogical Societies and the North Bay Field Trip Association.

#### Bulletin Submission Policy

Submission deadline is the second Friday following the General Meeting (normally the second Wednesday of the month.) Anonymous contributions will not be considered for publication in the Petrograph; however, if requested at the time of submission, the contributor's name can be withheld. Members are encouraged to submit articles that may be of interest to the general membership. The bulletin editor reserves the right to edit any submitted articles or omit any submission from publication. Source must be cited for material quoted from other authors. Permission to reprint Petrograph articles is hereby granted provided properly cited.

#### 2015 MGSCV Officers

##### Elected

President - Bonnie Andrade	<a href="mailto:President@mgscv.org">President@mgscv.org</a>	
Vice President - Neil Delfino	<a href="mailto:VP@mgscv.org">VP@mgscv.org</a>	
Secretary - Betty Milam	<a href="mailto:Secretary@mgscv.org">Secretary@mgscv.org</a>	(510) 589-8858
Treasurer - Sheryl Cooper	<a href="mailto:Treasurer@mgscv.org">Treasurer@mgscv.org</a>	
1 <sup>st</sup> Year Director - Michelle Bennette	<a href="mailto:Director1@mgscv.org">Director1@mgscv.org</a>	
2 <sup>nd</sup> Year Director - Jodi Minshall	<a href="mailto:Director2@mgscv.org">Director2@mgscv.org</a>	
3 <sup>rd</sup> Year Director - Norm Hodgson	<a href="mailto:Director3@mgscv.org">Director3@mgscv.org</a>	
Federation Director - Mike Mc Bride	<a href="mailto:Federation@mgscv.org">Federation@mgscv.org</a>	
Shop Manager Neil Delfino	<a href="mailto:ShopManager@mgscv.org">ShopManager@mgscv.org</a>	
2014 Show Chairman - Cathy Miller	<a href="mailto&gt;ShowChair@mgscv.org">ShowChair@mgscv.org</a>	
Membership - Tony Cooper	<a href="mailto:membership@mgscv.org">membership@mgscv.org</a>	510-589-5292
Editor -Diana Cohoon	<a href="mailto:Editor@mgscv.org">Editor@mgscv.org</a>	925-3483000
Past President -	<a href="mailto:pastpresident@mgscv.org">pastpresident@mgscv.org</a>	

##### Appointed

Scholarship Chair - Mark Montgomery  
Librarian - Mark Montgomery  
Historian - Norm Hodgson  
Purchasing Agent - Beth Farmer

## MGSCV Petrograph September 2018

### Monthly Bulletin of the Mineral and Gem Society of Castro Valley, inc.

Education Coordinator - Shirley

Buschke

Field Trip Coordinator-Mike Cox

[Mikecox.34ford@gmail.com](mailto:Mikecox.34ford@gmail.com)

Parliamentarian -

Reception/Host - Jim Ewing

Sunshine Reporter - All members

Door Prizes - Bonnie Andrade

Web Master - Tony Cooper

[webmaster@MGSCV.org](mailto:webmaster@MGSCV.org)



Publication Staff



✧Contributors: **Shirley Buschke, Betty Milam, Sheryl Cooper,**

### BOARD MEETING

June 12th.2018

By **Jodi Minshall**

The meeting was called to order at 7:10 PM by **Bonnie Andrade**. In attendance were **Bonnie Andrade, Neil Delfino, Mike McBride, Cathy Miller, Michelle Bennette, Jodi Minshall,** and **Norm Hodgson**.

**Treasurer's Report:** Report was presented by Cathy Miller since **Sheryl Cooper** is on vacation. **Neil Delfino** moved to accept the treasurer's report as presented, **Mike McBride** seconded the motion.

**Shop Manager:** **Neil Delfino** reported that 12" slab saw and trim saw blades have been changed.

Temporary Shop Supervisor for Wednesday from 10:00 to 2:00 will be Cathy Miller, and for Saturday Mike McBride will be the Temporary Shop Supervisor for the morning session from 9:00 to 1:00. We are looking for permanent Supervisors for these time slots. If you are interested please contact Neil Delfino to arrange training.

**CFMS Representative:** **Mike McBride** says the CFMS show will be in Chico this year. If you are interested in putting in a display case you will need to fill out an application. See Mike for the details.

**Show Chairman:** **Cathy Miller** reported that the next show committee will be September 11<sup>th</sup> at the shop, and after the Board meeting concludes. Approximate start time 7:45 PM.

Advertising for the next show will start being placed in trade magazines in June and will continue over the next couple of months as the deadlines come up.

There are flyers available at the shop for members to take to any shows or events they plan to visit.

There is usually a place at each show where flyers can be dropped off for easy distribution to the visiting public.

### GENERAL MEETING MINUTES

6/19/2018

Submitted by **Sheryl Cooper**



### ROCK RUMBLES

#### ROCK RUMBLES SEPTEMBER 2018

By **Shirley Buschke**

The auction case could use a little more. So far entries have been from **Pat**

## MGSCV Petrograph September 2018

### Monthly Bulletin of the Mineral and Gem Society of Castro Valley, inc.

and **Ed Rigor** and new member, **Annikka Blattel**.

So sorry to hear about the passing of **Betty Milam's** husband. He used to bake the turkey for our Christmas dinner and about two years ago he renovated our display cases.

Happy to know that **Teresa Tanaguchi's** missing sterling silver thimble has been found. She uses it in her demonstration at our annual show.

**Beth Farmer** just got back from in interesting trip to the special "Olympics" in Salt Lake City for patients who had had organ transplants. There were over 3000 participants and all were organ recipients. They compete in such games as field and track, darts etc. One of her relatives had a double lung transfer, 70 years old, and she won gold in darts

**Lily Johnson** took an intensive two week class in metal smithing and she said it was worth every penny. She even bought an interesting setting tool new on the market.

She usually has a piece in our auction case. Look for it. She is already pretty proficient in this art. Hope she will pass on some of her knowledge. **Lyle Shoeff** has also decided to get smart. He has enrolled in a similar class at S.F. Junior College. He will be there on Monday and Wednesday for the quarter.

My grandson and wife just returned from a trip to Japan. They said the place was spotless. We should try to emulate them. And we can start right here in the shop. Clean up equipment after use. That includes

washing out cylinders used to return your castings. There is often a residue in the cylinder. Clean it out. Wipe down equipment after use. Thank you.

**Bill Luna** is off to Idaho soon for ten days. He will probably check out any casinos that they might have. **Sharon Blattel** and husband just returned from a cruise to Alaska.

Several gem shows coming up soon. Monterey show is September 15 and 16 at the Fairgrounds. Chico is at the same time at their Fairgrounds. Why not make it a mini vacation? Lodi Show is at the Grape Festival Grounds on September 22 and 23 iS. And another one -- Redwood City at the Community Activities Building on Roosevelt Avenue on September 15 and 16. Now that is close. The 15th and 16th seems to be a very busy date,

**Beth Farmer** is also going to take an intensive week long jewelry class.

## SHOW SCHEDULES

### SEPTEMBER

**September 15 - 16: MONTEREY, CA**

Carmel Valley Gem & Mineral Society

Monterey County Fairgrounds

2004 Fairgrounds Road

Hours: 10 - 5 daily

Contact: **Janis Rovetti**, (831) 372-1311

Email: [janis12@sbcglobal.net](mailto:janis12@sbcglobal.net)

Website: [www.cvgms.org](http://www.cvgms.org)

**MGSCV Petrograph September 2018**

**Monthly Bulletin of the Mineral and Gem Society of Castro Valley, inc.**

**September 15 - 16: REDWOOD CITY, CA** 13337 Main Street (corner of Main & Trona Rd)

**Sequoia Gem & Mineral Society**

Community Activities Building

1400 Roosevelt Avenue

Hours: 10 - 5 daily

Contact: **William Spence**, (408) 398-7502

Email: bill.spence777@sbcglobal.net

Website:

[www.sequoiagemandmineralsociety.org](http://www.sequoiagemandmineralsociety.org)

Show Page

**September 22 - 23: LODI, CA**

**Stockton Lapidary & Mineral Club**

Lodi Grape Festival Grounds

413 East Lockford Street

Hours: 10 - 5 daily

Contact: **Mike Mathis**, (510) 301-3612

Email: mmathis@nwp.org

**October 6 - 7: GRASS VALLEY, CA**

Nevada County Gem & Mineral Society

Nevada County Fairgrounds

11228 McCourtney Road

Hours: 10 - 5 daily

Contact: **Mitchell Frank Van Hecke**, (530) 274-2425

Email: 4vanclan5@att.net

Website: [www.ncgms.org](http://www.ncgms.org) Show Page

**October 13 - 14: TRONA, CA**

**Searles Lake Gem & Mineral Society**

Gem Show Building

Hours: Sat 7:30 - 5; Sun 7:30 - 4

Contact: **Jim & Bonnie Fairchild**, (760) 372-5356

Email: slgms@iwvisp.com

Website: [www1.iwvisp.com/tronagemclub](http://www1.iwvisp.com/tronagemclub)  
Show Page

**October 14: FALLBROOK, CA**

**Fallbrook Gem & Mineral Society**

Fallbrook Gem & Mineral Museum

123 West Alvarado Street

Hours: 9 - 4

Contact: **Janice Bricker**, (760) 728-1130

Email: info@fgms.org

Website: [www.fgms.org](http://www.fgms.org)

**October 13 -14: LOS ALTOS, CA**

**Peninsula Gem & Geology Society**

Los Altos Youth Center

One North San Antonio Road

Hours: 10 - 5 daily

Contact: **Steve Jobe**, (408) 834-5384

Email: steve\_job@sbcbglobal.net

Website: [www.pggs.org](http://www.pggs.org) Show Page

**October 20 - 21: SANTA ROSA, CA**

**Santa Rosa Mineral & Gem Society**

The Veterans Memorial

1351 Maple Avenue

Hours: Sat 10 - 6; Sun 10 - 5

Contact: **Jolene**, (707) 849-955

# NBFT Fall Meeting

Saturday, September 22<sup>nd</sup>, 2018

Location: **Community Presbyterian Church**  
200 East Leland Road  
Pittsburg, CA 94565

Hosted by the **Contra Costa Mineral and Gem Society**

**Schedule:** 8:30 - 9:30  
Registration / Social with donuts and coffee  
9:30 - 12:00 Business Meeting  
12:00 - 1:00 Potluck Lunch  
1:00 - 3:00 Conclude Business Meeting  
Program to be announced

This is a centrally located meeting site that is convenient for all NBFT clubs. Please bring material for the silent auction: rocks and specimens from past field trips, rock related "white elephants" (old books, findings, tools, etc.), lapidary/jewelry items, and the like. Bring food to share (hot dish, cold dish, salad or dessert) for the potluck. Also, bring your own plate and eating utensils. This meeting is not just for field trip chairmen and leaders, so be sure to invite **all** of your club members who are

interested in field trips, collecting and getting great buys on rocks and specimens.

In addition to reports of summer field trips we will have election of Directors and bids to host the Spring meeting. We will also have announcements of fall, winter and spring field trips. And it is not too early to start thinking about 2019 trips. Each NBFT club is expected to host a shared field trip or related activity each year. Start your planning now so that your club will have a field trip or event to share.

**Directions:** Take Hwy 4 to Pittsburg. Exit on to Railroad Ave. Go south on Railroad to Leland Rd., approximately 1/2 miles. Turn left (east) and go 1/4 mile, then turn right into church parking lot. Easiest access is from south side of church.

For more information contact Dick Pankey at 925-439-7509 or dickpankey@juno.com

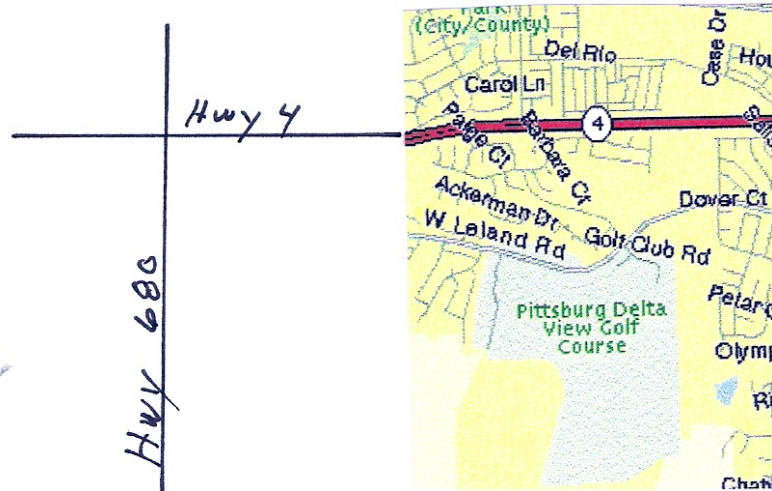

**MGSCV Petrograph September 2018**  
**Monthly Bulletin of the Mineral and Gem Society of Castro Valley, inc.**



**GEM OF MONTH**

**By Shirley Buschke**

This month's gem was born in Hayward and has been coming to the shop for several years. She graduated from Dublin High School. She loves pets and has a zoo at home. She has a rabbit and a bird, some kind of a parrot, that has the freedom of the house. Yes, the bird is house broken. She loves loves animals.

It is just recently that she has returned to the shop. Her first introduction had been to beads which she worked on at home. Ann Marie Korchendorf was her teacher when she came to the shop. She has worked at our show, usually at the children's Spin-a Wheel. Her favorite stones are "any that are pink, probably faceted tourmaline."

She recently had her first experience doing lost wax and has several settings to show for it. She has been hoping to learn wire wrap. Without a teacher, she has

managed a couple of pieces. Ed Rigor was quite impressed with her imagination. She also has a couple necklaces in the auction case. Right now, she and a boyfriend are planning to get married and are looking for a house. Unfortunately not close by.

Have you guessed yet? Her mother, grandmother and grandfather were/are active members. She often visited the other shop when she was three or four years old when Horace Robertson used to baby sit her. Remember the old shop was at a school and it had a playground and Horace used to let her play on the swing, etc. Our gem makes her living as a dog groomer. Now you know her -- **Annikka Blattel, Shirley Buschke's grand daughter.**

September 2018

**KIDS KORNER**

By: **Isabelle Bennette** Age 13

There is no Kids Korner for June.

**MGSCV Petrograph September 2018**  
**Monthly Bulletin of the Mineral and Gem Society of Castro Valley, inc.**  
**Shop Schedule**  
**(All shop session's members only)**

**MAP**

- Monday** 10 AM to 1 PM, Lapidary  
 6 PM to 9 PM, Beginners only in lapidary
- Tuesday** 12-to 5 PM, need daytime supervisor  
 6 PM to 9:00 PM, Lapidary,
- Wednesday** 9AM to 12:00PM, Lapidary  
 Library open 10AM to noon.  
 5:30 - 8:00 PM Lapidary
- Thursday** 10:00 AM to 1:00 PM, Lapidary  
 7 PM to 9 PM, Lapidary
- Friday** 9-1 PM Lapidary, Faceting (experienced only)
- Saturday** 9 AM to 3 PM, Faceting Class 9-12, Juniors,  
 w/supervisor's approval, lapidary  
 Library open 10AM to noon.
- Sunday** 9:30AM to 12:30 PM, Lapidary

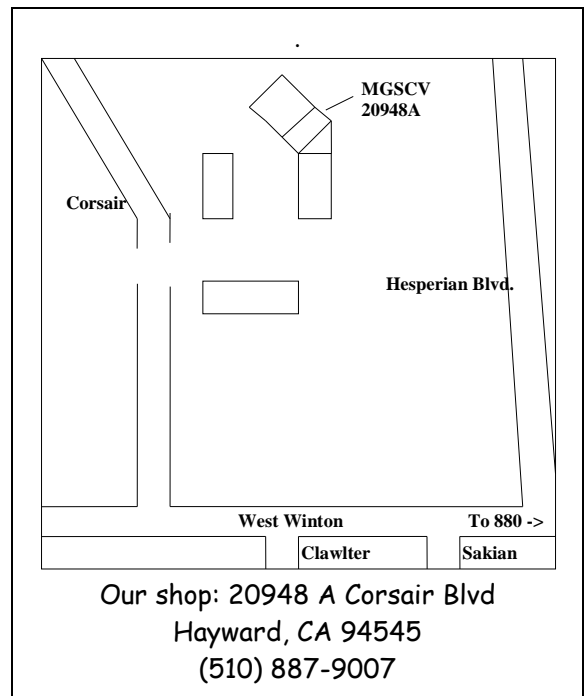

**SHOP NOTICES:**

Email us at [info@mgscv](mailto:info@mgscv)



**MGSCV Petrograph September 2018**  
**Monthly Bulletin of the Mineral and Gem Society of Castro Valley, inc.**



**From I 580: Take the A Street exit and go west, turn right on Montgomery Street and go to 22307 Montgomery Street.**

**From I 880: Take the A Street exit and go East. Turn left on Montgomery Street and go to 22307 Montgomery.**

**From Jackson Street: Go north on Mission Boulevard, turn left onto A Street, then right on Montgomery Street and go to 22307 Montgomery Street.**

## MGSCV Petrograph September 2018

### Monthly Bulletin of the Mineral and Gem Society of Castro Valley, inc. Mineral & Gem Society of Castro Valley (MGSCV) Membership Application and Information



Membership is good for one calendar year from January 1st through December 31st. Please fill out and sign the application. Mail the completed form, a check for the dues **payable to MGSCV**, and a self-addressed, stamped envelope to - **MGSCV, Attn: Membership Chair, P.O. Box 2145, Castro Valley, CA 94546.**

Your membership is active upon receipt of your check and application. It will be processed and membership cards will be at the shop within 4 weeks. Your email will be added to the list for the Petrograph, our newsletter. Your name will be added to the roster in the lobby at the workshop and in the drawing at the general meetings for cash prizes, if present.

We are a non-profit club whose sole purpose is the education of lapidary arts and geological sciences for all who are interested. **No products produced in the shop can be sold for profit.** All members should have or be familiar with the MGSCV Handbook. A copy is available for review in the club's lobby or one can be emailed to you by sending a request to [info@mgscv.org](mailto:info@mgscv.org).

Before any member may operate any equipment or take any class they must have completed an orientation and their first cabochon. **To schedule an orientation send an email to [WorkShopManager@mgscv.org](mailto:WorkShopManager@mgscv.org) with your name, phone number, and a good time to call you.** During the orientation you will learn about the club and get a tour of the workshop. Monday evenings are reserved for beginners only.

Membership dues cover less than 10% of our annual operating costs. It is our annual show that funds the club, workshop and all activities. **\*A requirement of membership is that every member must work at the show for a minimum of 4 hours.** The show is always held the first full weekend of March, so mark your calendars. The show is fun to work and is the reason we have the best workshop/club in Northern California. Shop services such as rock sawing, casting, special classes (faceting, wire wrap, metal work, etc...) will not be available to members who do not work at the show.

Membership Chairperson

Type of Membership(s):     new membership     renewal membership     Lifetime (voted in by the board)

* With Shop privileges	Junior Membership	NO Shop Privileges
<input type="checkbox"/> Single - \$45	<input type="checkbox"/> Junior (11-17 with adult) - \$1	<input type="checkbox"/> Single - \$35
<input type="checkbox"/> Couple - \$80	<input type="checkbox"/> Junior (11-17 without adult) - \$5	<input type="checkbox"/> Couple - \$60

After July 1st all **new** membership dues are half (1/2)

Name(s) (Please print all the names.)

Adults: \_\_\_\_\_

Juniors: \_\_\_\_\_

Address: \_\_\_\_\_

City: \_\_\_\_\_ State: \_\_\_\_\_ Zip: \_\_\_\_\_ Phone Number: \_\_\_\_\_

E-mail Address: \_\_\_\_\_

(Our monthly newsletter, the Petrograph, will be emailed to this address.)

Occupational Skills: \_\_\_\_\_

(Sometimes we are in need of advice and/or help in regards to electrical, plumbing, mechanical, clerical or other skills.)

Confidentiality: (check all that apply)    **I do not want** my \_\_\_\_\_ phone \_\_\_\_\_ email printed in the roster at the shop.

I agree with the By-laws and rules of the Mineral & Gem Society of Castro Valley (MGSCV).

Members Signatures: \_\_\_\_\_

**Mineral & Gem Society of Castro Valley (MGSCV)  
Membership Application and Information**